

ITEM	QTY.	DESCRIPTION
1	1	MOTOR - 1750 RPM, INDUSTRIAL DUTY, HP PER ORDER, PAINTED FINISH
2	1	BEARING HOUSING - ALUMINUM, W/ HOLLOW BORE COUPLING, PAINTED FINISH
3	1	ISOLATION MOUNTS - 8.5" X 8.5" STAINLESS PLATE
4	1	SHAFT - 316 STAINLESS STEEL SHAFT PER ORDER
5	1+	IMPELLER - 316 STAINLESS STEEL MARINE-TYPE IMPELLER, SIZE AND QTY, PER ORDER

#### STANDARD FEATURES

- CAST ALUMINUM HOUSING
- DUAL OVERSIZE ABEC-RATED BEARINGS
- STAINLESS PLATE MOUNT
- STAINLESS HOLLOW BORE COUPLING
- STAINLESS HARDWARE

#### AVAILABLE UPGRADES

- 32Ra SANITARY FINISH ON WETTED PARTS
- EXPLOSION PROOF MOTOR (VFD IS NOT XP COMPLIANT AND IS SHIPPED LOOSE FOR MOUNTING IN A SAFE AREA IN COMPLIANCE WITH ALL APPLICABLE REGULATIONS.)

#### ISOLATION MOUNT

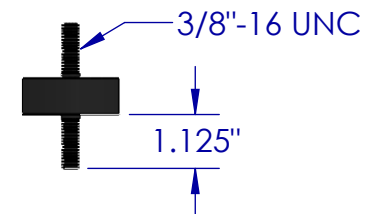

#### PLATE MOUNT DETAIL

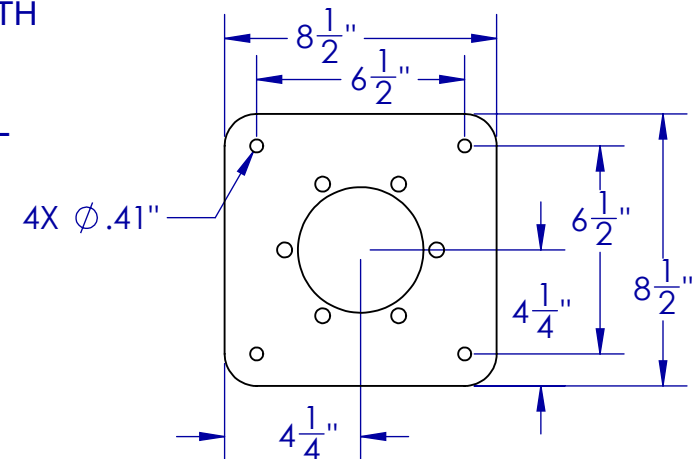

#### VFD MOUNT DETAIL

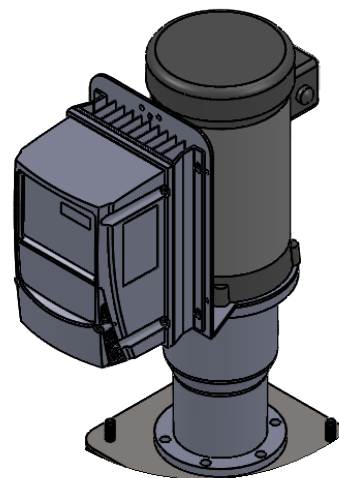

NOTE: ALL STAINLESS VERSION IS AVAILABLE  
STAINLESS STEEL VERSION INCLUDES: STAINLESS STEEL MOTOR, STAINLESS HARDWARE, STAINLESS BEARING HOUSING (WITH VITON O-RING UPPER SEAL AND VITON LIP SEAL LOWER SEAL)

UNLESS OTHERWISE SPECIFIED:  
DIMENSIONS ARE IN INCHES.  
NO TOLERANCE IS IMPLIED.  
DO NOT SCALE DRAWING

NAME	DATE
DRAWN SB	6/03/22
CHECKED DP	6/06/22
PROPRIETARY AND CONFIDENTIAL	
THE INFORMATION CONTAINED IN THIS DRAWING IS THE SOLE PROPERTY OF FUSION FLUID EQUIPMENT LLC. ANY REPRODUCTION IN PART OR AS A WHOLE WITHOUT THE WRITTEN PERMISSION OF FUSION FLUID EQUIPMENT LLC IS PROHIBITED.	
WHILE FUSION FLUID EQUIPMENT LLC STRIVES TO MAINTAIN THE INTEGRITY OF A DESIGN AS APPROVED, FUSION FLUID EQUIPMENT LLC RETAINS THE RIGHT TO MAKE MODIFICATIONS DURING THE MANUFACTURING PROCESS TO IMPROVE FIT, FORM, AND FUNCTION OF THE DESIGN WITHOUT CUSTOMER NOTIFICATION OR CONSENT.	

FusionExpress Mixing Equipment	
TITLE: FUSION PRO PD-P DIRECT DRIVE - PLATE MOUNT WITH VFD	
SIZE DWG. NO. A SALES-PD-#P-#-V#	REV B
SCALE: 1:1	WEIGHT: SHEET 1 OF 1