

ROTATION

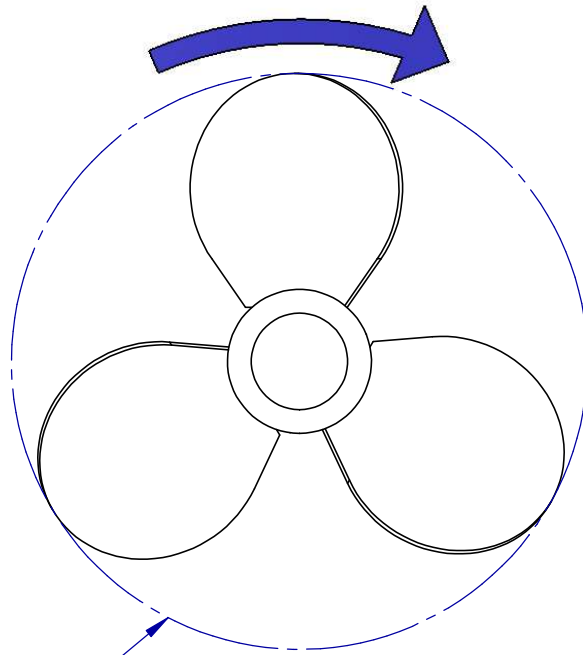

IMPELLER DIAMETER

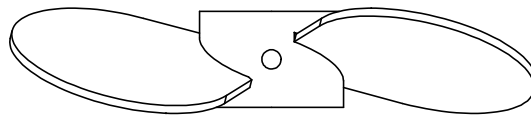

FLOW

AVAILABLE UPGRADES  
 •20 Ra SANITARY FINISH  
 •8 Ra SANITARY FINISH

CONTACT FUSION FLUID EQUIPMENT FOR CUSTOM  
 SIZES AND BORES

# IMPELLER DATA

MATERIAL	316SS
FLOW	AXIAL
BLADE ANGLE	25° NOMINAL
ATTACHMENT	SET SCREW
FINISH	32 Ra

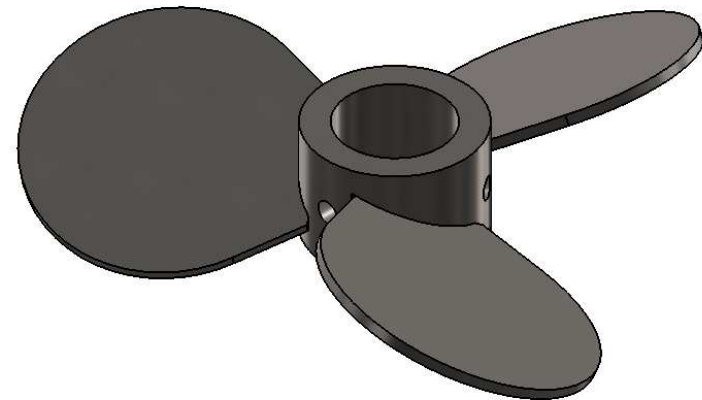

DRAWN	JDF	7/25/13
CHECKED	TS	7/25/13

**PROPRIETARY AND CONFIDENTIAL**  
 THE INFORMATION CONTAINED IN THIS  
 DRAWING IS THE SOLE PROPERTY OF FUSION  
 FLUID EQUIPMENT LLC. ANY REPRODUCTION IN  
 PART OR AS A WHOLE WITHOUT THE WRITTEN  
 PERMISSION OF FUSION FLUID EQUIPMENT LLC IS  
 PROHIBITED.

WHILE FUSION FLUID EQUIPMENT LLC  
 STRIVES TO MAINTAIN THE INTEGRITY OF A  
 DESIGN AS APPROVED, FUSION FLUID  
 EQUIPMENT LLC RETAINS THE RIGHT TO MAKE  
 MODIFICATIONS DURING THE MANUFACTURING  
 PROCESS TO IMPROVE FIT, FORM, AND  
 FUNCTION OF THE DESIGN WITHOUT CUSTOMER  
 NOTIFICATION OR CONSENT.

**FusionExpress**  
 Mixing Equipment

TITLE: SANITARY BIOPROP (3 BLADES)		
SIZE <b>A</b>	DWG. NO. 000000	REV <b>A</b>
SCALE: 1:2	WEIGHT:	SHEET 1 OF 1

UNLESS OTHERWISE SPECIFIED:  
 DIMENSIONS ARE IN INCHES.  
 NO TOLERANCE IS IMPLIED.  
 DO NOT SCALE DRAWING